



PROMARINE®-450T



Product description

PROMARINE®-450T is a non-combustible autoclaved calcium silicate board, formulated without asbestos and formaldehyde, with excellent fire performance; ideal for installation and application in the marine market for A, B and C Class divisions.

Properties

- smooth and consistent surface finish
- suitable for bonding with high pressure laminates
- easy to work, cut and fix
- moisture resistant

Technical data				
Colour		Off-white		
Surface conditions		Smooth, sanded		
Nominal density (tolerance) (EN 12467)	kg/m ³	450 (±15%)		
Reaction to fire		Non-combustible Certificate Number: 164.109/1121 /WCL MED 475TE		
Class divisions		A0 Bulkhead	A60 Bulkhead	B15 Bulkhead
Panel thickness	mm	19	19+19 with 10mm air gap	19
Panels joint ¹⁾		Solid spline	Solid Spline	Solid spline, "C" spline or Omega joint
Thermal conductivity 20 °C (hot wire method)	W/mK	0.138		
Alkalinity	pH	7-10		
Coefficient of expansion α	m/mK	2.4·10 ⁻⁶		
Moisture movement	%	< 0.1 (ambient to saturated)		
Moisture content				
Typical	%	< 5 (at despatch)		
Maximum	%	< 12		
Bending strength (oven dry, EN 12467)	N/mm ²	> 2.2		
Compressive strength (oven dry, EN 12467)				
5% deformation	N/mm ²	5		
10% deformation	N/mm ²	10		
Quality assurance	N/mm ²	Module D. Certificate WCL MED164.109/1121/0475QA		

¹⁾ See specific drawings on page 2.

Acoustic properties			
Thickness	mm	19	19+19 (+10mm air gap)
R _w index (ISO 717/1)	dB	27 ²⁾	36

²⁾ See ISO 10140/2 curve on page 2.

Dimensions (standard)			
Thickness (tolerance)	mm	16 (±0.4, double sanded)	19 (±0.4, double sanded)
Width (tolerance)	mm	1220 (±1)	1220 (±1)
Length (tolerance)	mm	2440 (±1)	2440 (±1)



PROMARINE®-450T

Areas of application

- A, B & C Class constructions
- Compartmentation
- Linings
- Non-combustible furniture

Workability

PROMARINE®-450T can be cut using normal woodworking tools or by using circular blades. During cutting operations use personal protective equipment (see below).

Handling

PROMARINE®-450T should be worked and installed using appropriate personal protective equipment (PPE). Use protective gloves, glasses, suitable respiratory equipment

Acoustic properties

19mm, $R_w=27$ [dB]

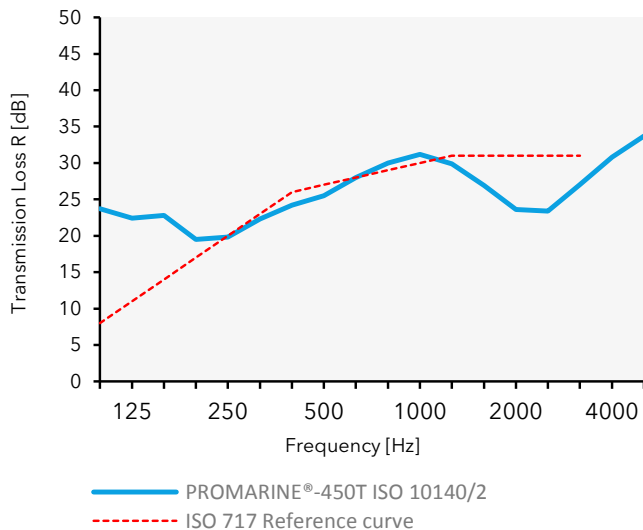

to avoid health effects, and suit. Use dust extraction when worked inside. After use, thoroughly wash hands and any other parts that could have been in contact with the material. For further information refer to Safety Information Sheet.

Waste disposal

Refer to local legislation. If not available: The board is not classified as a dangerous substance and so no special provisions are required regarding the carriage and disposal of the product to landfill.

Storage

Store on a flat surface, in a dry area.

Class divisions - joint drawings

Solid spline



"C" spline

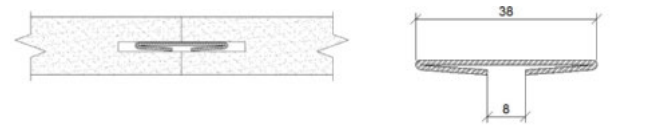

Omega joint

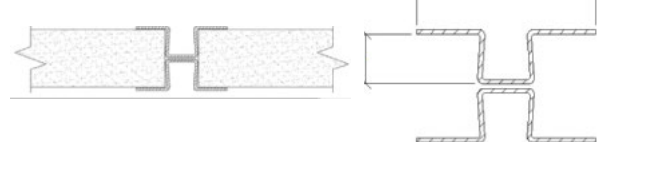

All specified technical data are mean values from the production which are subject to the usual fluctuations and do not represent guaranteed properties in the sense of a guarantee. All information corresponds to the current state of the art and has been presented and described to the best of our knowledge. Changes due to new findings are possible, errors and misprints are not excluded. With regard to any liability, our delivery and payment terms apply exclusively. Request safety datasheet. With the publication of this edition, all previously published datasheets are invalid.
© Copyright Etex NV, Brussels, Belgium. All rights reserved. 2018-09